

# Medium-duty door operator

## Garaga model PMJ -specifications

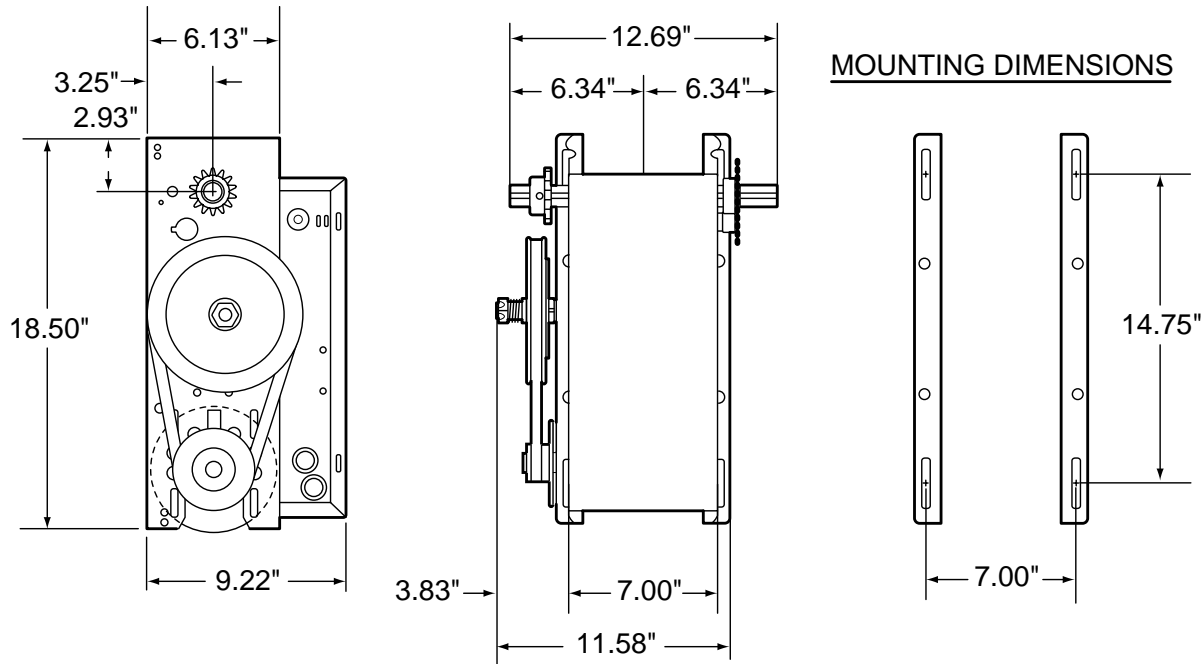

### STANDARD FEATURES

■ **Model specific:**

Work included – The electric operator will be Garaga Model PMJ as manufactured by The Chamberlain Group, Inc. Related work – Door preparation, miscellaneous or structural metal work, field electrical wiring, wire, conduit, fuses and disconnect switches are in the scope of work of other divisions or trades.

■ **Product:**

Supply Model PMJ, medium-duty, cUL listed, belt drive jackshaft type operator(s) rated 1/2 H.P., \_\_\_\_ Volts, \_\_\_\_ Phase.

■ **General:**

Provide cUL listed electric door operator assembly of size and capacity recommended by door manufacturer; complete with electric motor and factory-prewired motor controls, solenoid brake, 3-button OPEN/CLOSE/STOP control station, conduit and wiring from control to motor and accessories required for proper operation.

■ **Electric motor:**

Motor shall be high starting torque 1/2 H.P. rated for a maximum capacity of 12 cycles per hour, protected against overload by an internal automatic reset thermal overload device.

■ **Control circuit:**

24V NEC Class 2 Circuit with a 20 VA transformer.

■ **Frame and reduction:**

Primary speed reduction shall be heavy-duty 4L V-belt and #41 chain and sprocket reduced secondary. Operator shall be equipped with an adjustable friction clutch, and floor level disconnect, output and door driven sprocket shall be provided with the operator. Operator shall be capable of mounting on either left or right side of door and shall be capable of driving the door at a speed of approximately 8 to 9 inches per second.

■ **Limit switches:**

Fully adjustable, driven linear type limit switch mechanism shall synchronize the operator with the door. Low friction nylon limit nuts fitted on threaded steel shaft, rotating on oilite self-lubricating bronze bushings. The motor shall be removable without affecting the limit switch settings.

■ **Execution:**

Install the motor operator in accordance with Lift-Master instructions and standards and in compliance with applicable federal, state or local regulations.

■ **Warranty:**

Garaga Commercial Door Operators and accessories shall be warranted to be free of any defect in materials and workmanship for a period of two years.

**Lift-Master**  
**The Professional Line**  
**Commercial Operators**

For more information call Garaga at: (418) 227-2828

or fax Garaga at:

(630) 530-6098 or (516) 467-2566

Garaga's e-mail:

[info@garaga.com](mailto:info@garaga.com)

8500, 25th Ave. St-Georges • Québec, Canada G6A 1K5

CUSTOMER \_\_\_\_\_

PROJECT \_\_\_\_\_

ARCHITECT / ENGR \_\_\_\_\_

CONTRACTOR \_\_\_\_\_

DRAWING NUMBER \_\_\_\_\_

DATE \_\_\_\_\_

SHEET \_\_\_\_\_

OF \_\_\_\_\_

## SHOP DRAWING

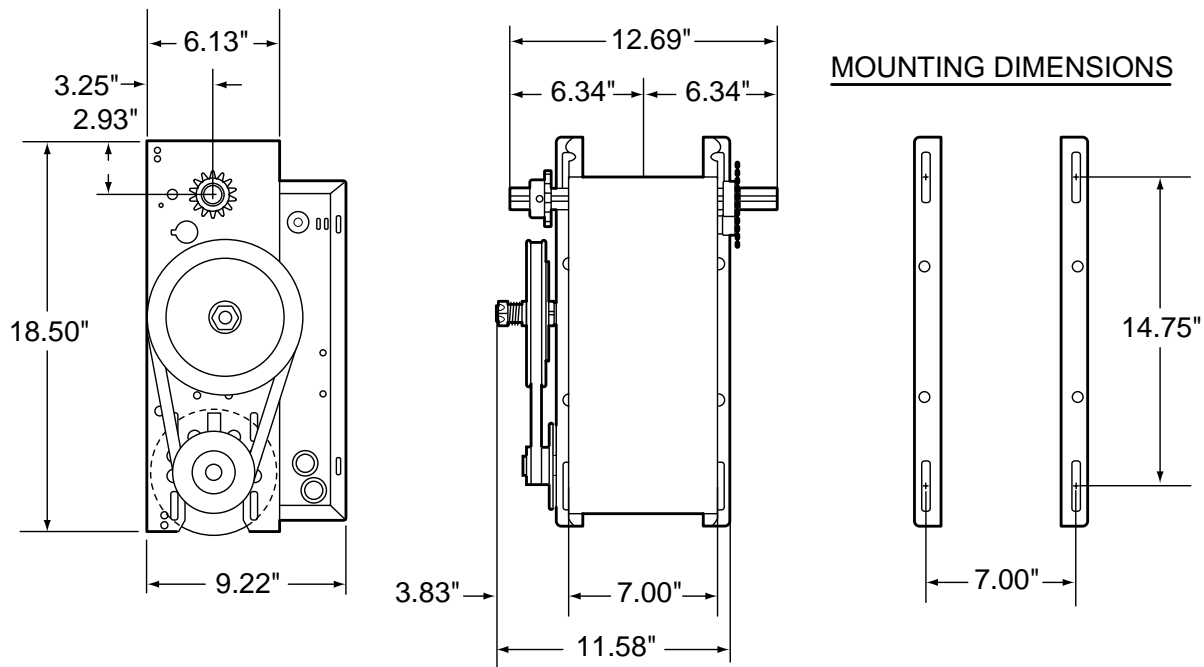

### SPECIFICATIONS FOR ORDERING:

- 1) SUPPLY \_\_\_\_\_ ( ) GARAGA OPERATORS(S) MODEL \_\_\_\_\_  
\_\_\_\_\_ HP, \_\_\_\_\_ VOLTS, \_\_\_\_\_ PHASE, \_\_\_\_\_ HERTZ.
- 2) FOR \_\_\_\_\_ WIDE X \_\_\_\_\_ HIGH DOOR(S) WITH \_\_\_\_\_
- 3) SUPPLY OUTPUT DRIVE SPROCKET ON \_\_\_\_\_ SIDE OF OPERATOR.
- 4) SUPPLY \_\_\_\_\_ ( ) OPEN / CLOSE / STOP CONTROL STATION(S) IN NEMA \_\_\_\_\_ ENCLOSURE PER OPERATOR.
- 5) SUPPLY AUXILIARY AND OPTIONAL EQUIPMENT AS SPECIFIED BELOW (one per operator unless otherwise noted)

### NOTES:

- 1) REFER TO MODEL PMJ PRODUCT DATA SHEET FOR GENERAL INFORMATION
- 2) REFER TO DRAWING \_\_\_\_\_ FOR WIRING DIAGRAM

| MOTOR AMPERAGE RATING |                         |        |
|-----------------------|-------------------------|--------|
| HORSE POWER           | VOLTAGE - PHASE - 60 Hz |        |
|                       | 115-1Ø                  | 230-1Ø |
| 1/2                   | 6.5                     | 3.0    |